

XDL E3

Adaptive Directional | Fixed to 30° Tilt | Xmesh

3in
75mm

PRODUCT SPECIFICATION



Damp
Location

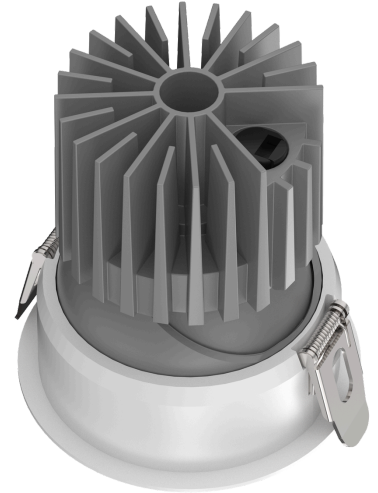
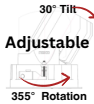

Product Features

- Industry leading 5 year warranty¹
- Utilizes Xicato XOB LED light source with best in class color consistency (1 X 2 SDCM)
- Superior light quality with high CRI options of 90 and 95
- World class driver electronics delivering true flicker-free dimming performance
- Cutting edge dimming performance down to 0.1%² with 0-10V, DALI-2 and Xmesh wireless control
- Adaptive 2-in-1 fixture design transforms a fixed downlight to adjustable up to 30° tilt
- Classic round or square shape with options of trimmed and trimless to compliment any design
- Flexible lighting design options with variety of light levels, beam angles, and color temperature
- Choose from various install types including retrofit, new construction, and insulated ceilings
- Xicato's Xmesh wireless connectivity enables remote control and monitor from app/dashboard
- Utilize Xicato's smart building ecosystem by adding sensors, switches and asset tags
- Double as emergency lighting with optional battery back-up

Ordering Logic

Model	Trim/Shape/Type	Output/CRI/CCT	Optics/Reflector	Housing Size/Install Type/Shape	Driver	Output/Wireless	Emergency	
EXAMPLE: E3-WRA-L29030-30DW-E3HBR-X10-L2 (XDL 3" White Round Adaptive Downlight, 1180Lm, 90CRI, 3000K, 30 Degree White Reflector, Retrofit Driver Box, XAD 0-10V, For L2)								
Model	Trim	Shape	Function	Output Level	CRI	CCT	Optics	Reflector
E3 XDL 3"	W White B Black T Trimless	R Round S Square	A Adaptive (0° to 30°)	L1 765 Lm L2 1050 Lm	90 90 95 95	27 2700K 30 3000K 35 3500K 40 4000K	18D ³ 18 Degree 24D 24 Degree 30D 30 Degree 40D 40 Degree 50D ³ 50 Degree	W Matte White B Matte Black S Matte Silver CB Chrome Black
Housing Size⁴	Install Type	Cutout Shape	Driver	Output Level⁵	Emergency Backup⁶			
E3H XDL 3" Housing	B Retrofit Driver Box F New Construct Frame I Insulated Ceiling Box	R Round S Square Blank Retrofit or No Housing	X10 0-10V Dim to 1% XD2 DALI-2 Dim to 0.1% X10X 0-10V with Xmesh Dim to 0.1% XD2X DALI-2 with Xmesh Dim to 0.1%	L1 L1 Output L2 L2 Output	Blank No Emergency E5 Emergency 90min @ 5W E9 Emergency 90min @ 9W			
D3H No Housing	A Air Tight IC Box C Chicago Plenum Blank No Housing							

1. See Xicato 5 Year Limited Warranty

2. Dimming down to 0.1% with Dali-2 and Xmesh; down to 1% with 0-10V

3. 18D only available in L1; 50D only available in L2

4. Housing can be shipped separately from base downlight

5. Must match Output Level of base downlight

6. All Emergency Backup options are CA Title 20 Compliant and includes remote test switch

Technical Specifications

Lighting	
LED	Xicato XOB
CCT	2700K, 3000K, 3500K, 4000K
Delivered Lumens	See Table
CRI	CRI ≥90 or CRI ≥95
LED Color Consistency	Xicato XOB with 1x2 SDCM Color Consistency
LED Rated Life (L70)	>50,000Hrs
Optical	
Beam Angle	18°, 24°, 30°, 40°, 50°*
Lens Material	Polycarbonate
UGR	TBD
Electrical	
Input Voltage	120-277V
Frequency	50/60Hz
Dimmable	Yes, 0-10V to 1%; DALI-2, Xmesh Wireless to 0.1%
Power Consumption	See Table
Efficacy	See Table
Mechanical	
Base/Housing	Integrated Aluminum Heatsink / 16-Gauge Rolled Steel
Trim Finish	Matte White, Matte Black, Trimless
Reflector Finish	White, Black, Silver, Chrome Black, Chrome Silver
Shape	Round, Square
Dimensions (H x Ø Dia)	With Trim: 3.54 x 3.27in (90 x 83mm)
Net Weight	0.5lb (250g)
Max Ambient Temp	35° C (95° F)
Application Type	Adaptive (Adjust from Fixed at 0° to 30° Tilt)
Installation	Retrofit, New Construction, Insulated Ceiling
Certification and Warranty	
Certification	ETL, UL2108, FCC, CE, CA Title 24 JA8, UKCA, RoHS
Environmental Rating	Damp Location Rated
Warranty	5 years Limited

*18° only available in L1 Output; 50° only available in L2 Output

Performance and Efficacy*			
Model	Output (lm)	Power (W)	Efficacy (lm/W)
L1	765	11	70
L2	1050	15	70

*All data based on 3000K CRI 90 as baseline

Lumen Conversion**		
CCT	CRI	Ratio
3000K	90	1
2700K	90	0.95
3500K	90	1.02
4000K	90	1.03
2700K	95	0.84
3000K	95	0.89
3500K	95	0.91
4000K	95	0.92
Beam Angle		Ratio
L1	18°	0.87
L1	24°	0.91
L1	30°	1
L1	40°	0.9
L2	24°	0.78
L2	30°	0.86
L2	40°	1
L2	50°	0.9

**Base for conversion: L1 based on 30°, L2 are based on 40°

Emergency Battery Back-Up			
		Est. Output Level	
Battery Option		L1	L2
E5	90min @ 5W	~59%	~42%
E9	90min @ 9W	x	~76%

All data shown is nominal. Specifications and data are subject to change without notice.

Dimensional Drawings

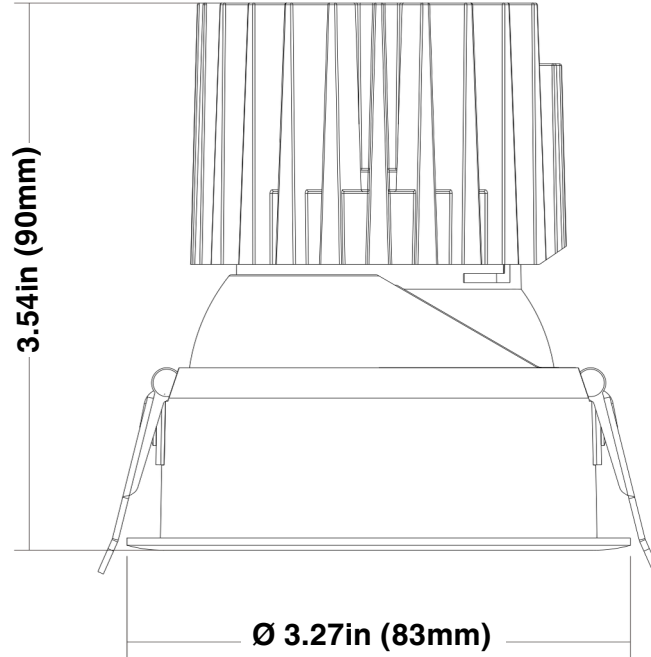

Other Dimensions

New Construction Plaster Plate

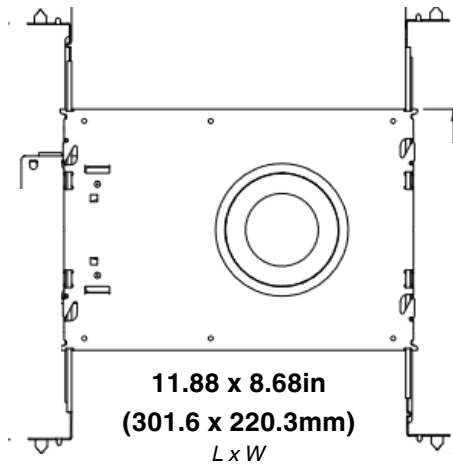

IC / ICAT / Chicago Plenum

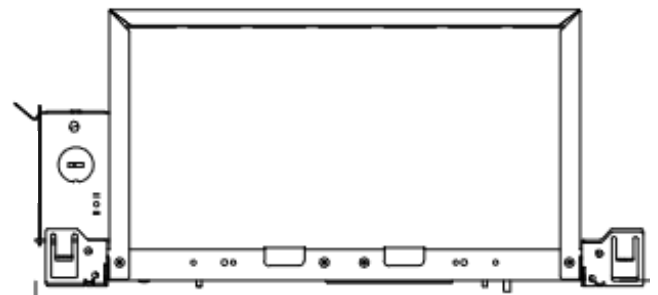

10.50 x 8.50 x 6.75
(266.7 x 215.9 x 171.5mm)
L x W x H
(Tentative, Subject to Change)

Ceiling Cutout Dimension

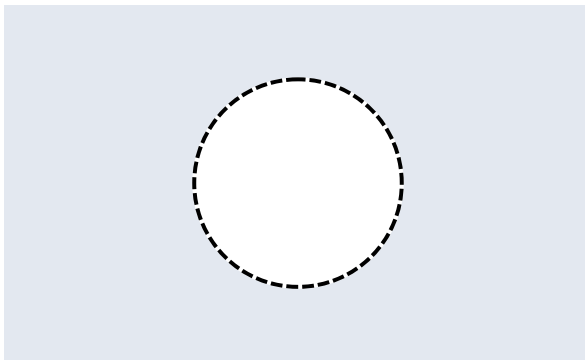

Round
Ø 2.95" (75mm)

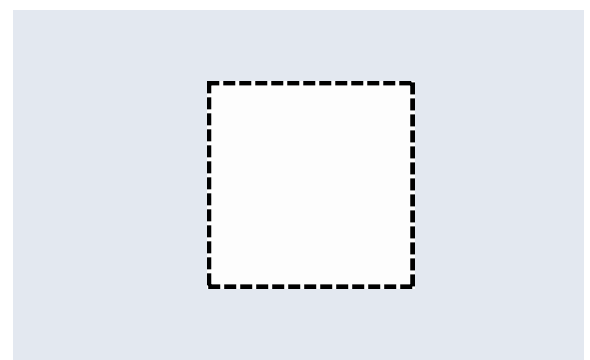

Square
2.95" x 2.95" (75 x 75mm)

Color Specification: TM-30 for Xicato XOB 3000K CRI 90

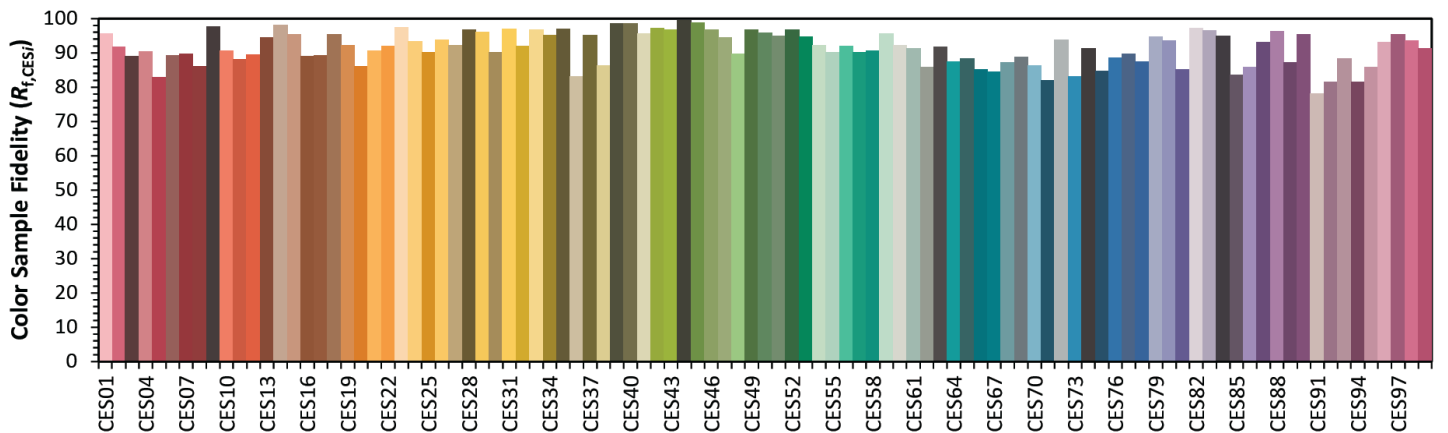
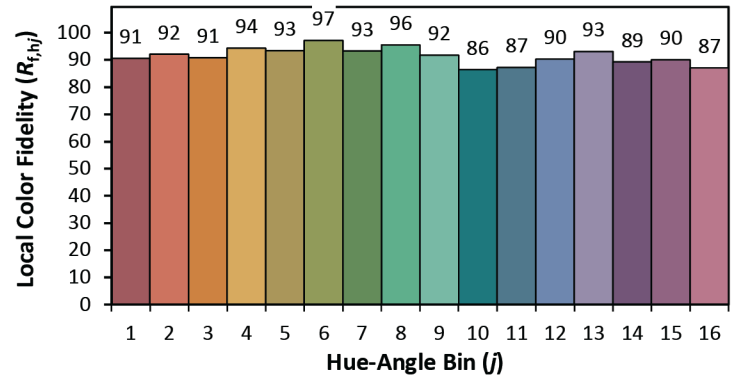
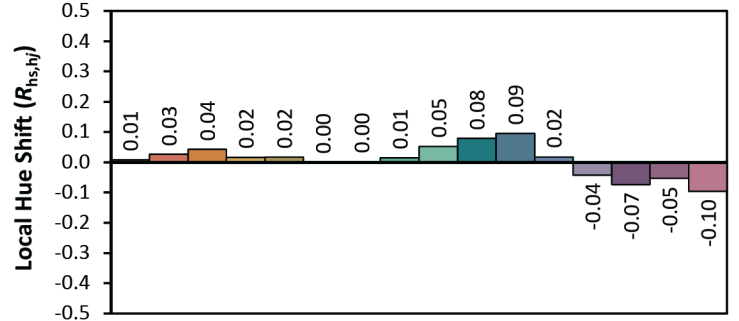
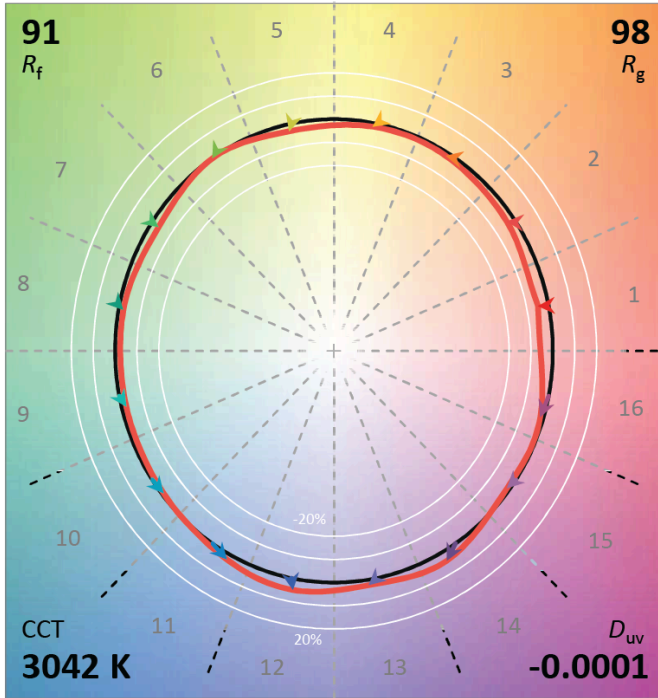
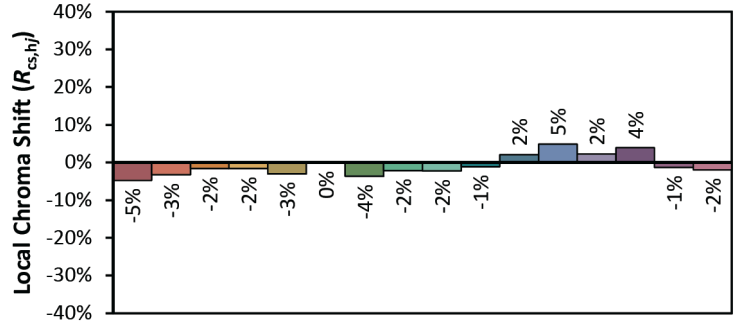
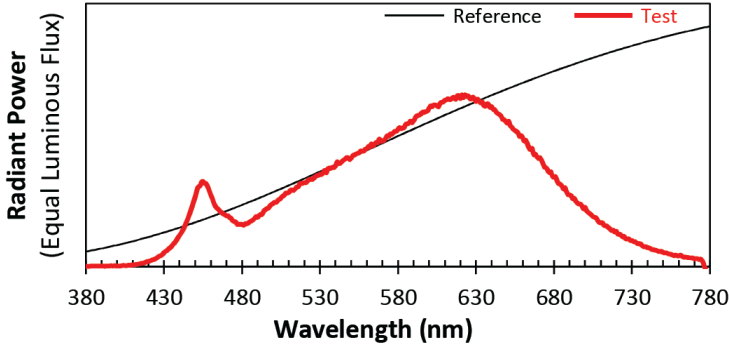

Notes: This is a recommended method for displaying IES TM-30-18 information.

x 0.4381
 y 0.4043
 u' 0.2512
 v' 0.5216

CIE 13.3-1995 (CRI)	
R_a	93
R_g	64

Colors are for visual orientation purposes only. Created with the IES TM-30-18 Calculator v2.0.

Color Specification: TM-30 for Xicato XOB 3000K CRI 95

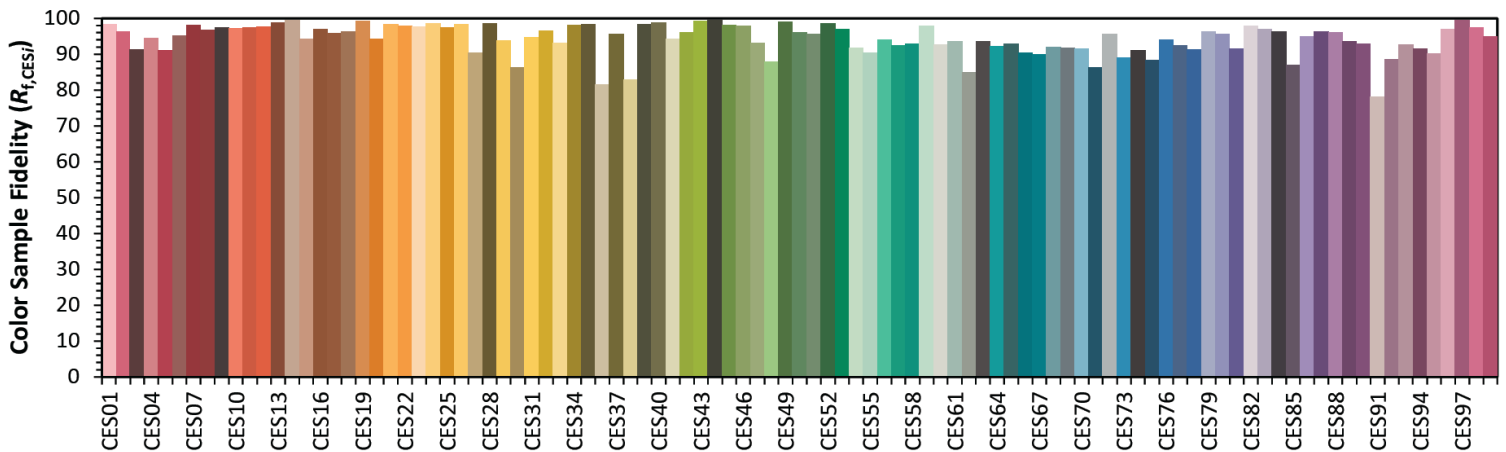
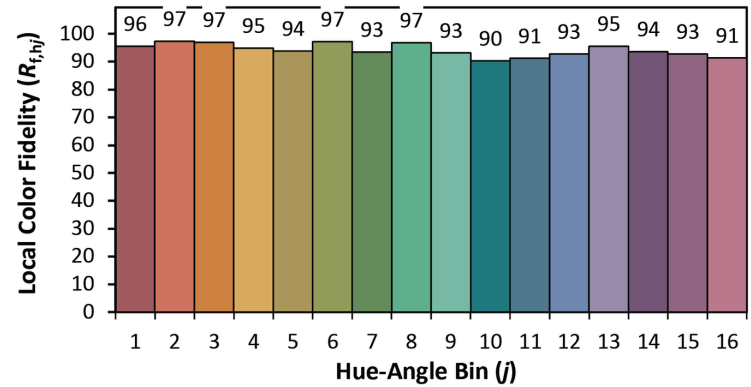
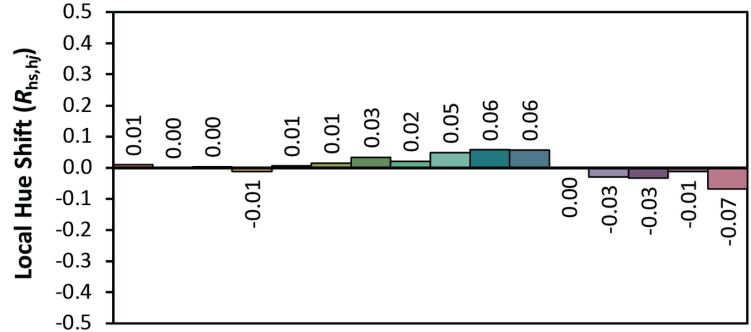
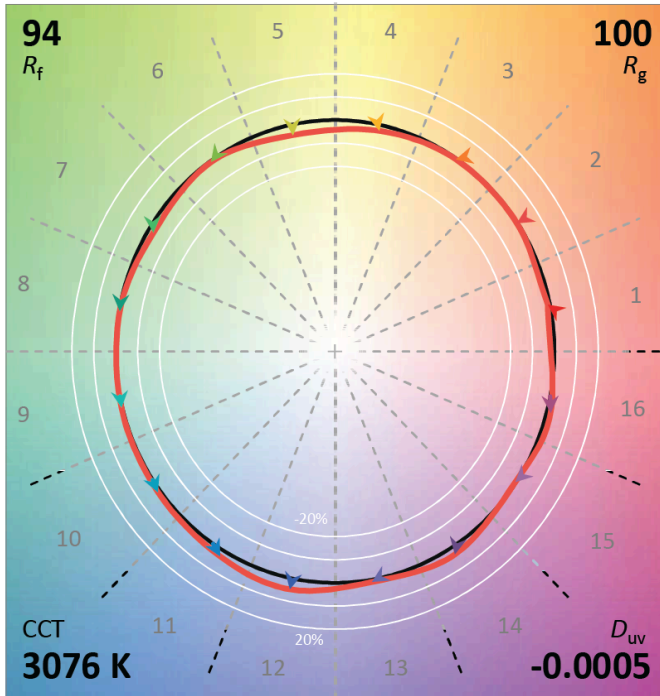
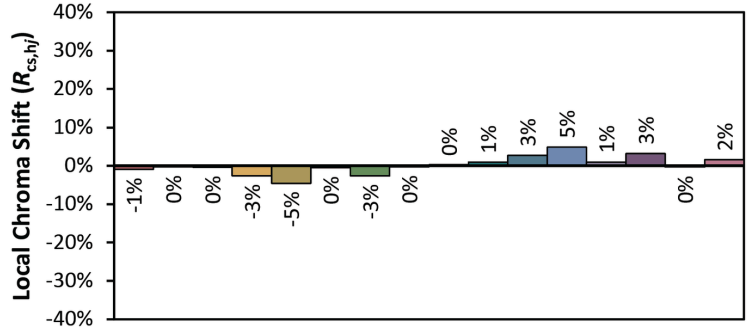
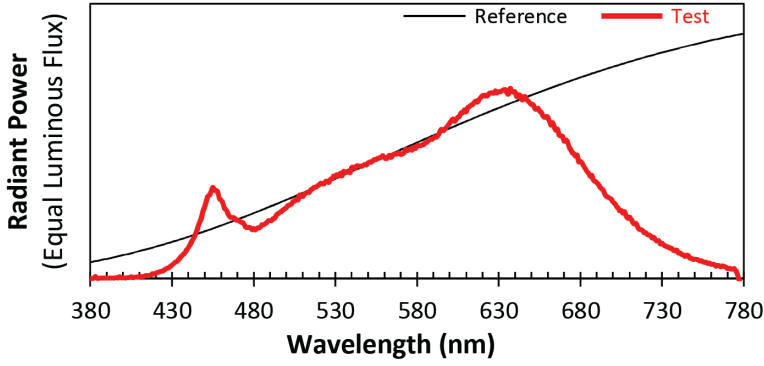

Notes: This is a recommended method for displaying IES TM-30-18 information.

x **0.4352**
 y **0.4022**
 u' **0.2502**
 v' **0.5204**

CIE 13.3-1995 (CRI)	
R_a	98
R_g	95

Colors are for visual orientation purposes only. Created with the IES TM-30-18 Calculator v2.0.