

XDL E6 XTM

Adaptive Directional | Wall Wash | Fixed to 30° Tilt

6in
150mm

PRODUCT SPECIFICATION

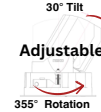

Product Features

- XDL E6 XTM Series offers exceptional and reliable performance backed by industry leading 10 year warranty¹
- Utilizes Xicato XTM light source with superior 1x2 SDCM color consistency with ZERO color shifts
- Xicato's patented Corrected Cold Phosphor Technology® provides exceptional light and color performance
- World class quality of light with CRI/R9 of up to 95/90
- High performing reliable driver electronics delivering true flicker-free dimming performance
- Cutting edge dimming performance down to 0.1%² with 0-10V, DALI-2 and Xmesh wireless control
- Adaptive 2-in-1 fixture design transforms a fixed downlight to adjustable with a simple adjustment
- Complimentary Wall Wash option delivers the desired lighting accent designers seek
- Classic square or round shape with options of trimmed and trimless to compliment any design
- Flexible lighting design options with variety of light levels, beam angles, and color temperature
- Choose from various install types including retrofit, new construction, and insulated ceilings
- Xicato's Xmesh wireless connectivity enables remote control and monitor from app/dashboard
- Utilize Xicato's smart building ecosystem by adding sensors, switches, and asset tags
- Double as emergency lighting with optional battery back-up

Housings can be shipped separately from base downlight. EM includes remote test switch.
*See Xicato 10 Year Limited Warranty
**Down to 1% with 0-10V dimming

¹36W only available for Wall Wash and only available in Matte Silver finish
²CRI 95 Vibrant only available in 3000K

Ordering Logic

Model	Trim/Shape/Type	Output/CRI/CCT	Optics/Reflector	Housing Size/Install Type/Shape	Driver	Output/Wireless	Emergency			
E6-WRA-L4X9030-30DW-E6XHBR-X10 (XDL E6 6" White Round Adaptive Downlight, 2450Lm, Xicato XTM, 90CRI, 3000K, 36 Deg White Reflector, Retrofit Driver Box, XAD 0-10V, For L4)										
Model	Trim	Shape	Function	Output Level	LED	CRI	CCT	Optics	Reflector	
E6	XDL 6"	W White	R Round	A Adaptive (0° to 30°)	L2 1160 Lm	X Xicato XTM	90 90	27 2700K	25D 25 Degree	W Matte White
		B Black	S Square	W Wall Wash	L3 1700 Lm			30 3000K	36D 36 Degree	B Matte Black
E6W	XDL 6" Wet Rated	T Trimless			L4 2465 Lm	V9 ³ V95	35 3500K	50D 50 Degree	S Matte Silver	
								40 4000K	36W ⁴ Wall Wash	CB Chrome Black
Housing Size ⁵	Install Type	Cutout Shape	Driver	Output Level ⁶	Emergency Backup ⁷					
E6XH	XDL 6" XTM Housing	B Retrofit Driver Box	R Round	X10 0-10V Dim to 1%	L2 L2 Output	Blank	No Emergency			
		F New Construct Frame	S Square	XD2 DALI-2 Dim to 0.1%	L3 L3 Output		E5	Emergency 90min @ 5W		
		I Insulated Ceiling Box	Blank Retrofit or No Housing	X10X 0-10V with Xmesh Dim to 0.1%	L4 L4 Output		E9	Emergency 90min @ 9W		
D6XH	No Housing	A Air Tight IC Box		XD2X DALI-2 with Xmesh Dim to 0.1%		E15	Emergency 90min @ 15W			
		C Chicago Plenum								
		Blank No Housing								

1. See Xicato 10 Year Limited Warranty
2. Dimming down to 0.1% with Dali-2 and Xmesh; down to 1% with 0-10V
3. V9 - CRI 95 Vibrant only available in 3000K
4. 36W only for Wall Wash and only available in Matte Silver or White finish
5. Housings can ship separately from the base downlight
6. Must match with Output Level of the base downlight
7. All Emergency Backup options are CA Title 20 Compliant and includes remote test switch

Technical Specifications

LED Light Source	
LED	Xicato XTM with Corrected Cold Phosphor Technology®
CCT	2700K, 3000K, 3500K, 4000K
Delivered Lumens	See Table
CRI/R9	CRI 90: ≥90/50, CRI 95: ≥95/90, CRI 95 Vibrant: ≥95/90*
LED Color Consistency	Xicato XTM with 1x2 SDCM Color Consistency
LED Rated Life (L70)	>50,000Hrs
Optical	
Beam Angle	25°, 36°, 50°
Lens Material	Polycarbonate
UGR	TBD
Electrical	
Input Voltage	120-277V
Frequency	50/60Hz
Dimmable	Yes, 0-10V to 1%; DALI-2, Xmesh Wireless to 0.1%
Power Consumption	See Table
Efficacy	See Table
Mechanical	
Base/Housing	Integrated Aluminum Heatsink / 16-Gauge Rolled Steel
Trim Finish	Matte White, Matte Black, Trimless
Reflector Finish	White, Black, Silver, Chrome Black, Chrome Silver
Shape	Round, Square
Dimensions (H x Ø Dia)	7.48 x 6.30in (190 x 160mm)
Net Weight	4.13lb (1.875kg)
Max Ambient Temp	35° C (95° F)
Application Type	Adaptive (Adjust from Fixed at 0° to 30° Tilt), Wall Wash
Installation	Retrofit, New Construction, Insulated Ceiling
Certification and Warranty	
Certification	ETL, UL2108, FCC, CE, UKCA
Environmental	RoHS
IP Rating	IP 55 with Lens Only
Warranty	10 years Limited

*CRI 95 Vibrant only available in 3000K CCT

XTM Designer (CRI 90) Performance and Efficacy*			
Model	Output (lm)	Power (W)	Efficacy (lm/W)
L2	1160	16.7	69.5
L3**	1700	24	70.8
L4	2465	34.1	72.3

XTM Artist (CRI 95) Performance and Efficacy*			
Model	Output (lm)	Power (W)	Efficacy (lm/W)
L2	1240	18.9	65.6
L3**	1710	24.0	65.3
L4	2235	36.8	60.7

*All data based on 3000K 36° Optics as baseline

**Estimated Value

Lumen Conversion*	
Beam Angle	Ratio
25°	0.9
36°	1
50°	0.97
Type	Ratio
Adaptive (0° to 30° Tilt)	1
Wall Wash	0.8

*All conversion based on 3000K as baseline

Emergency Battery Back-Up				
		Est. Output Level		
E6 XTM		L2	L3	L4
E5	90min @ 5W	~44%	~29%	~20%
E9	90min @ 9W	~79%	~53%	~35%
E15	90min @ 15W	x	~88%	~59%

All data shown is nominal. Specifications and data are subject to change without notice.

Dimensional Drawings

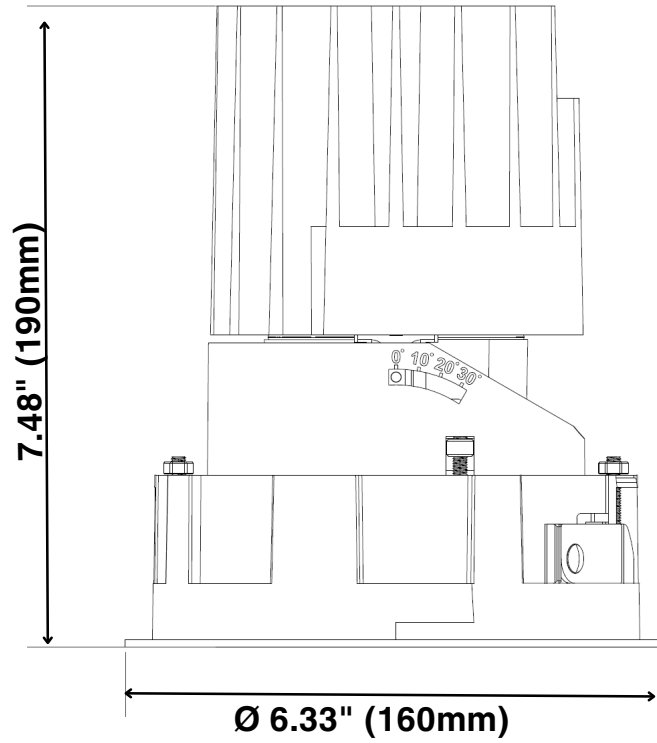

Ceiling Cutout Dimension

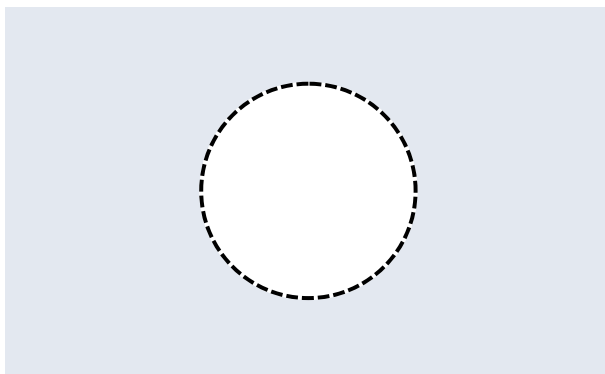

Round
Ø 5.91" (150mm)

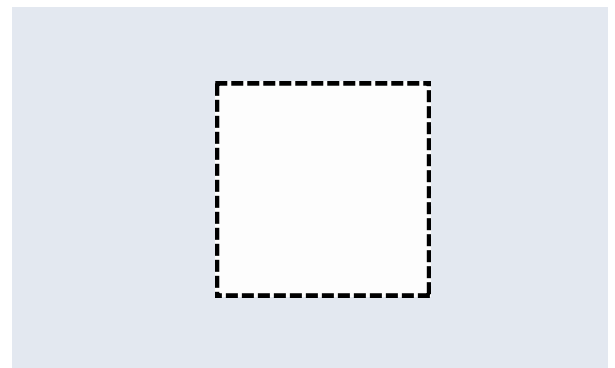

Square
5.91" x 5.91" (150 x 150mm)

Other Dimensions

New Construction Frame

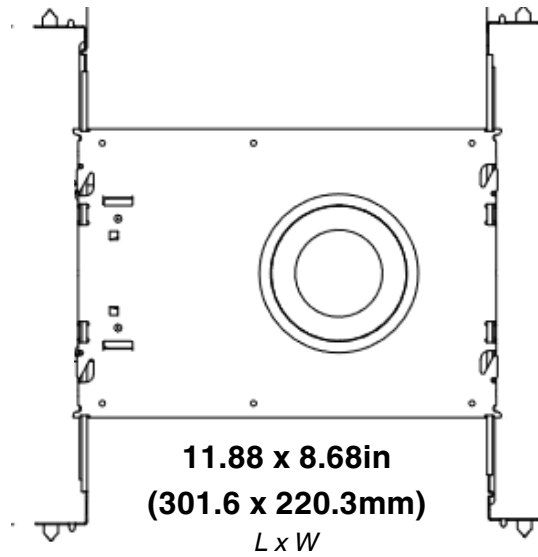

IC / ICAT / Chicago Plenum

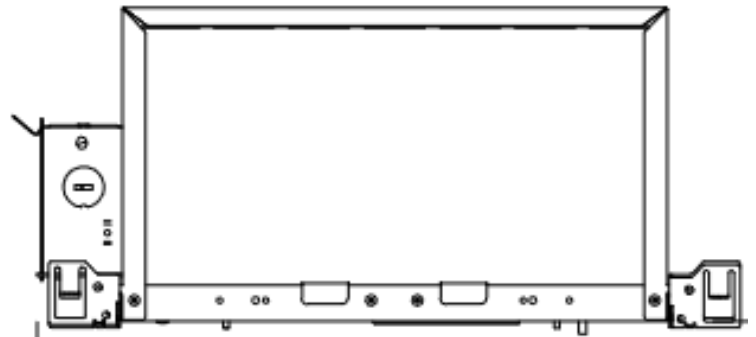

14.88 x 12.0 x 8.50in
(377.8 x 304.8 x 215.9mm)
L x W x H

Retrofit Driver Box

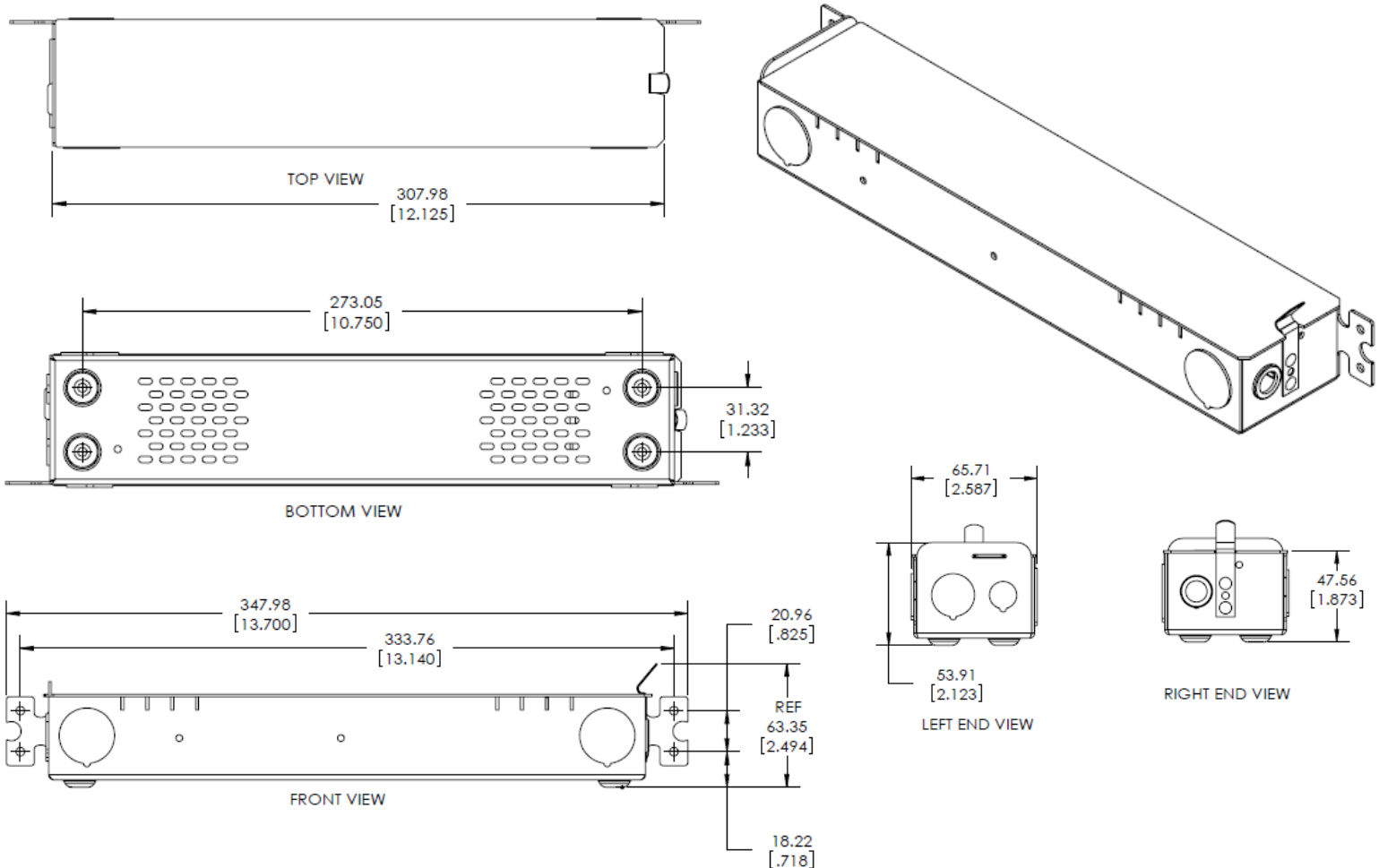

Color Specification: TM-30 for Xicato XTM 3000K CRI 90

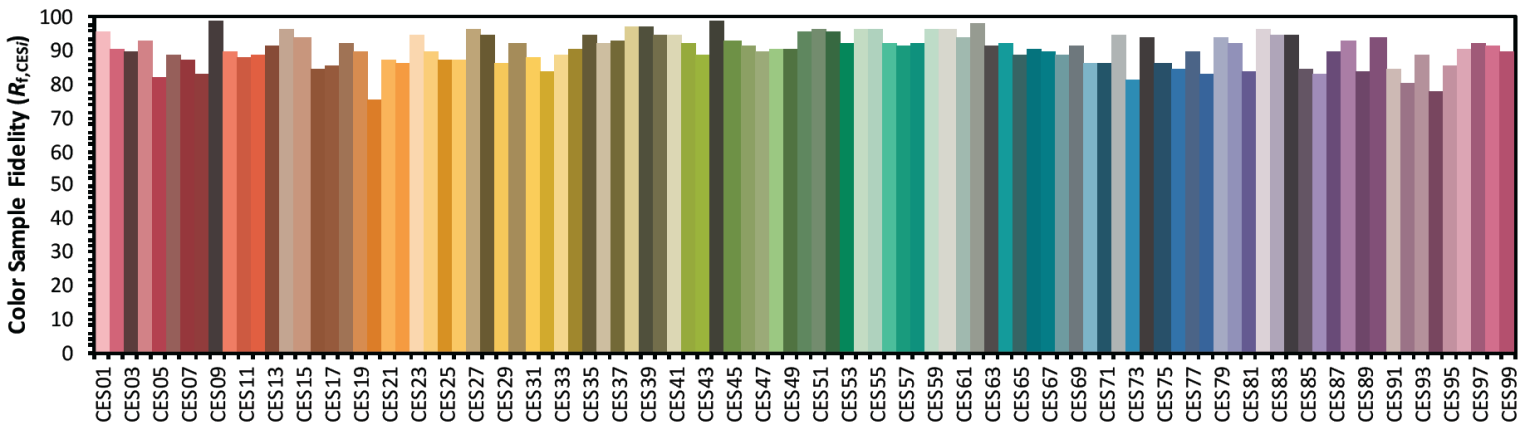
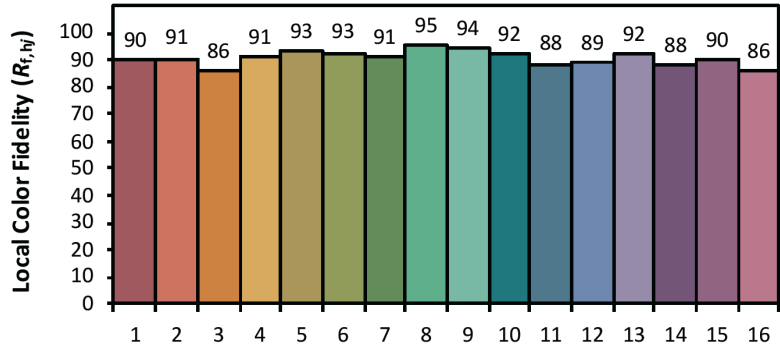
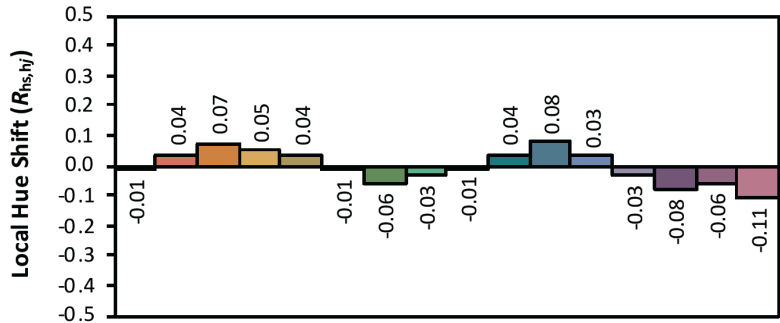
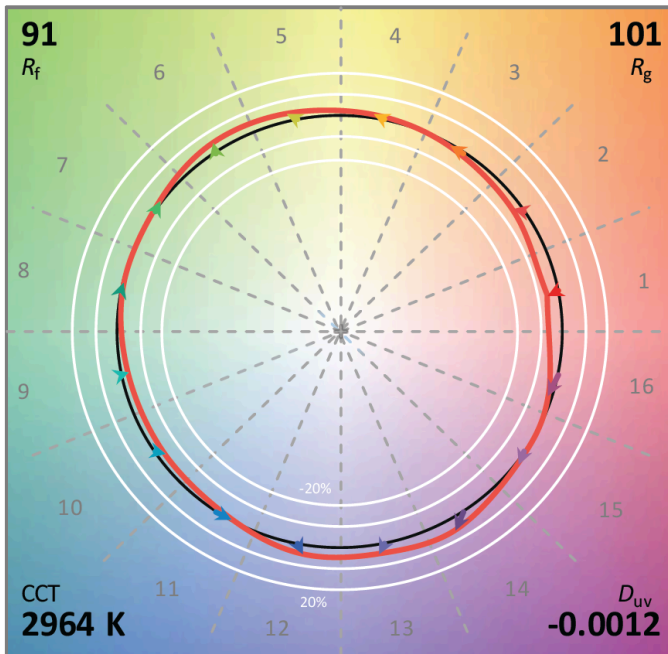
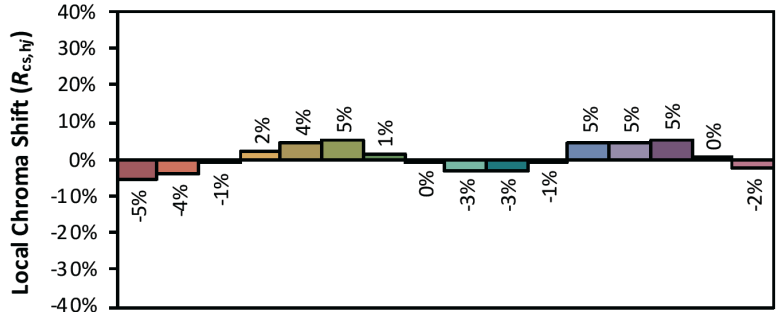
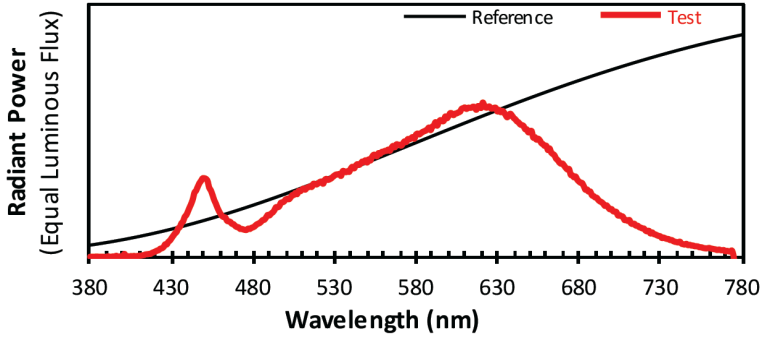

Notes: This is a recommended method for displaying ANSI/IES TM-30-18 information.

x 0.4377
 y 0.4013
 u' 0.2523
 v' 0.5204

CIE 13.3-1995 (CRI)	
R_a	91
R_g	55

Colors are for visual orientation purposes only. Created with the IES TM-30-18 Calculator v2.0.

Color Specification: TM-30 for Xicato XTM 3000K CRI 95

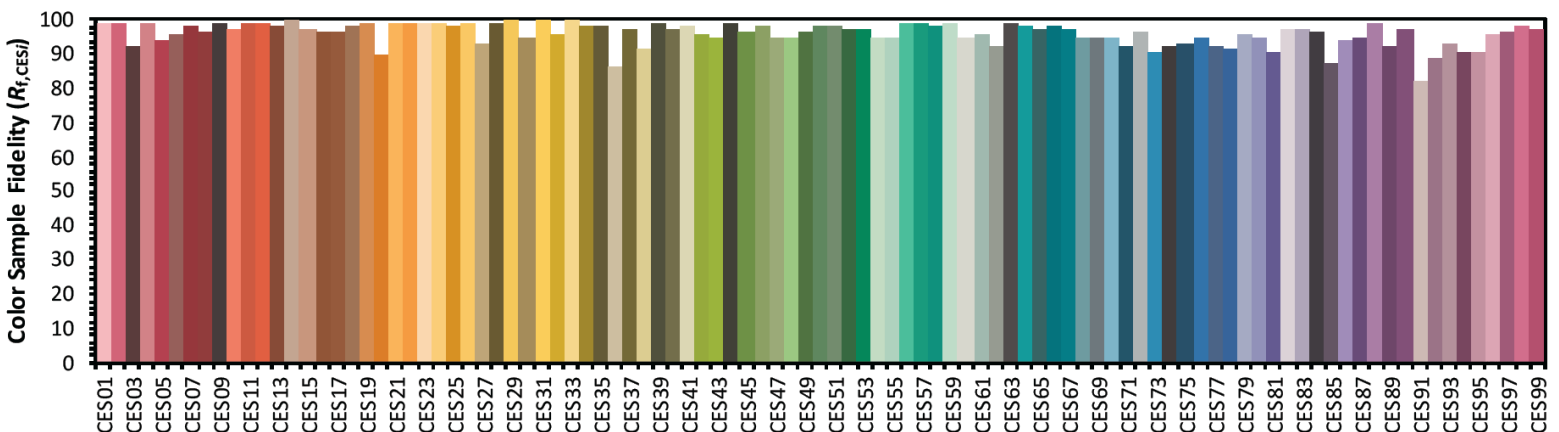
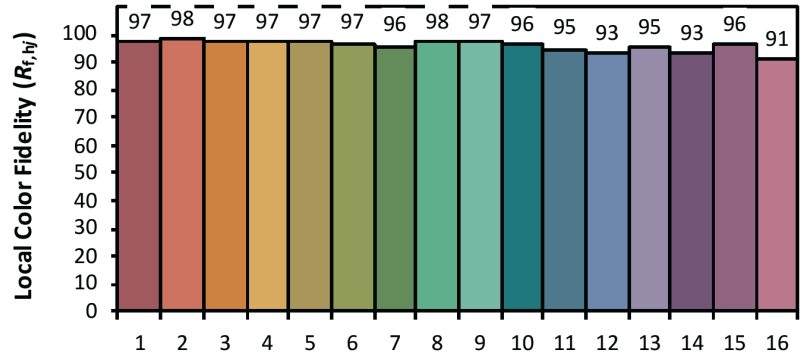
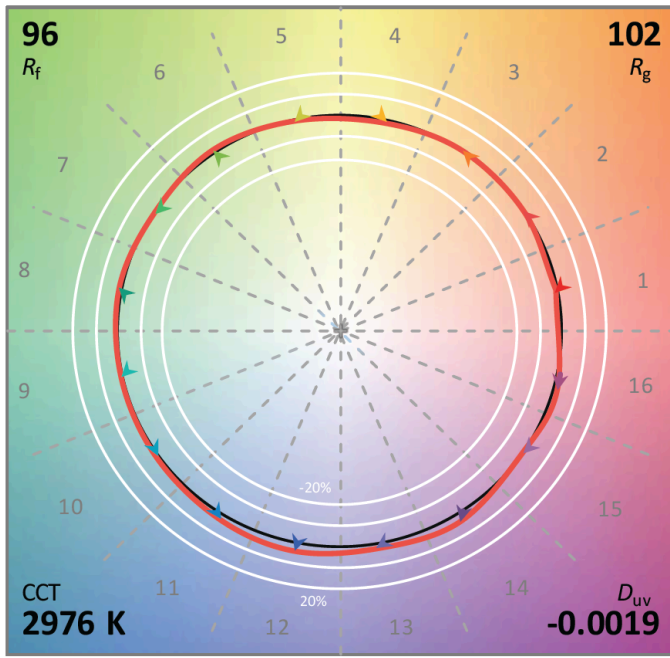
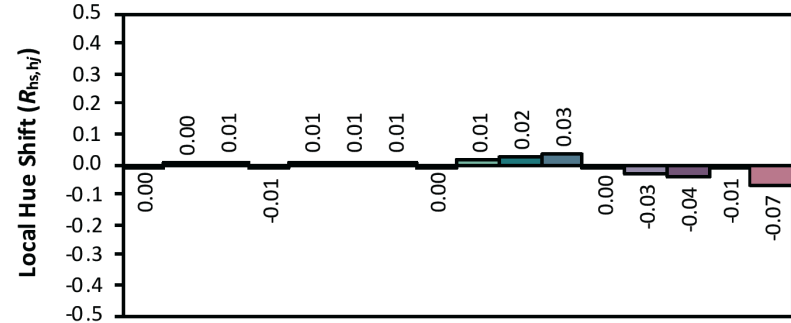
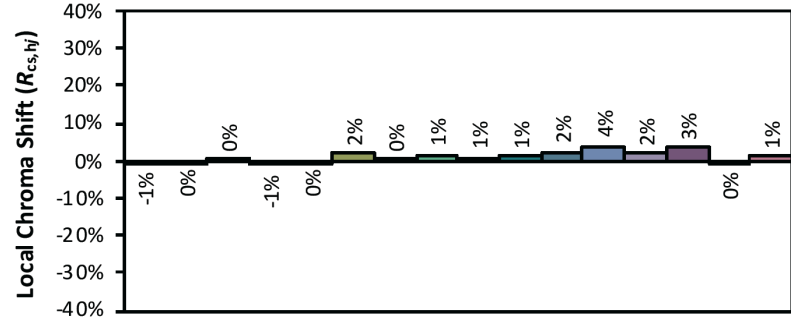
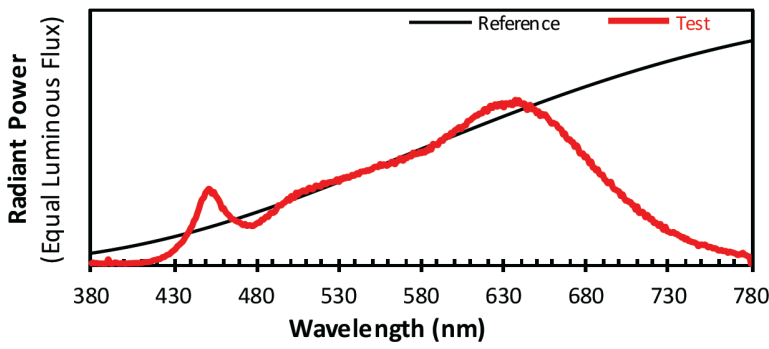

Notes: This is a recommended method for displaying ANSI/IES TM-30-18 information.

x **0.4359**
 y **0.3990**
 u' **0.2521**
 v' **0.5192**

CIE 13.3-1995	
(CRI)	
R_a	98
R_g	94

Color Specification: TM-30 for Xicato XTM 3000K CRI 95 Vibrant

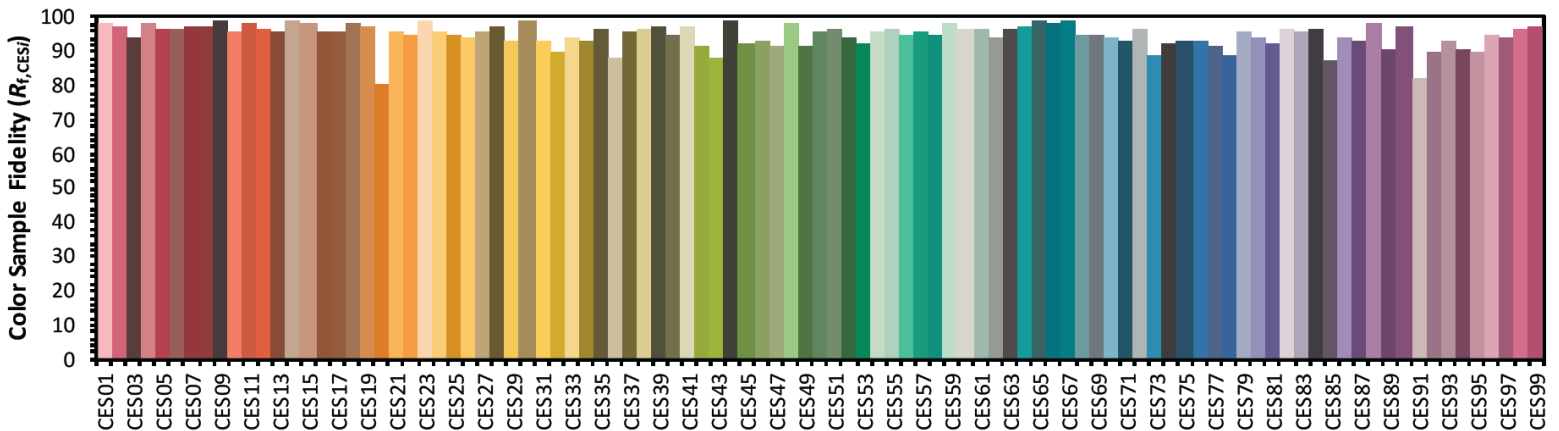
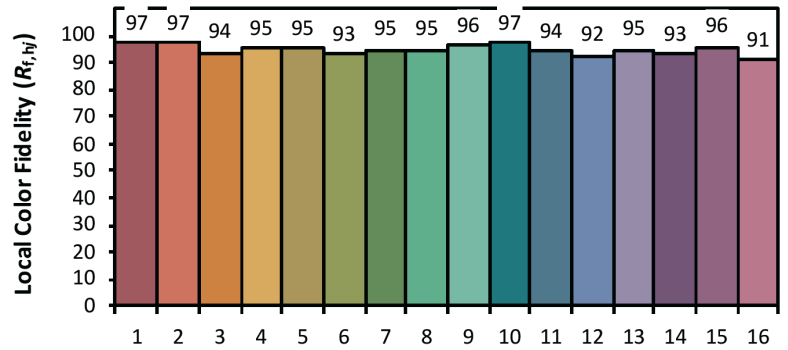
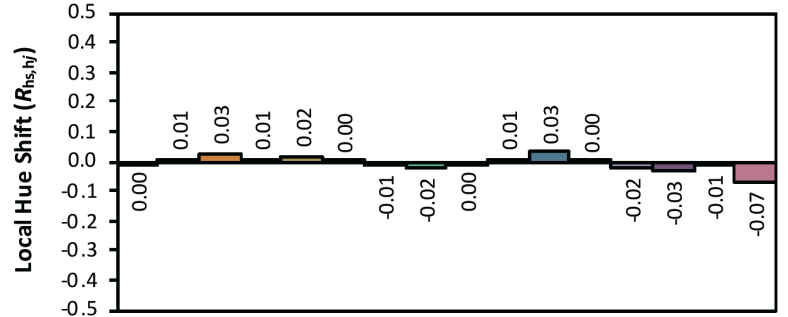
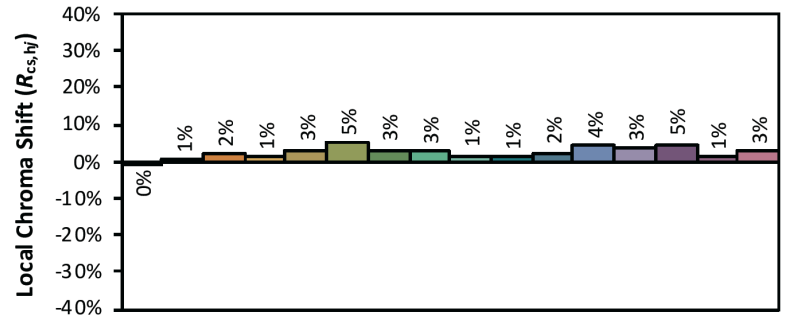
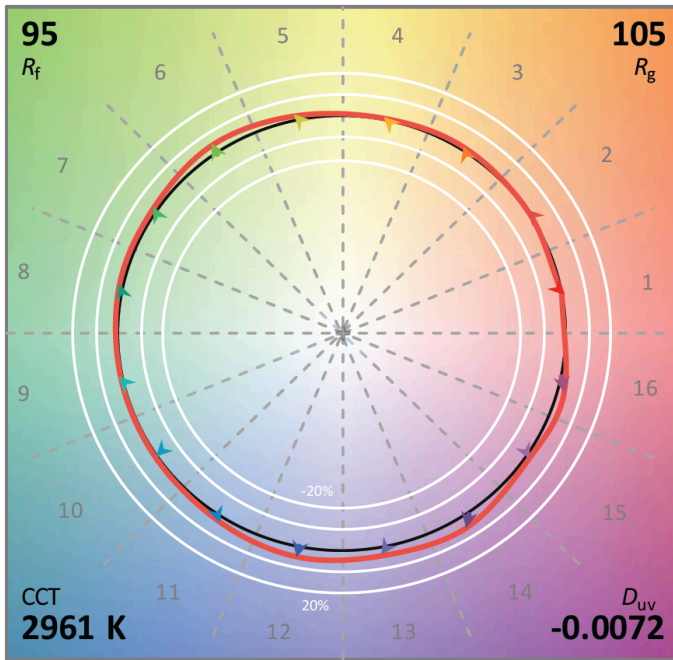
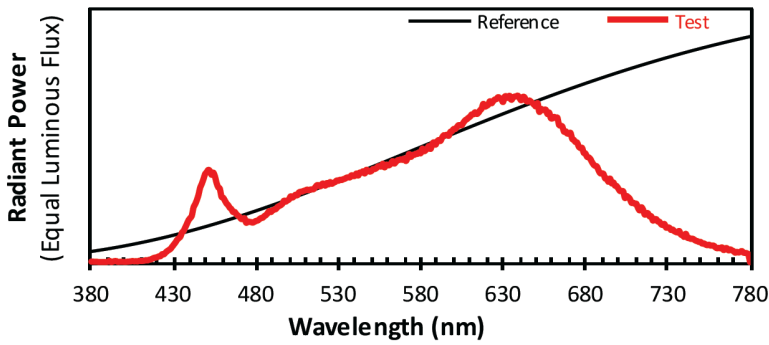

Notes: This is a recommended method for displaying ANSI/IES TM-30-18 information.

x **0.4293**
 y **0.3840**
 u' **0.2545**
 v' **0.5120**

CIE 13.3-1995	
(CRI)	
R _a	96
R _g	98

Colors are for visual orientation purposes only. Created with the IES TM-30-18 Calculator v2.0.