

# XDL E2

Adaptive Directional | Fixed to 30° Tilt | Xmesh

2.2in  
55mm

## PRODUCT SPECIFICATION

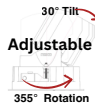

### Product Features

- Industry leading 5 year warranty<sup>1</sup>
- Utilizes Xicato XOB LED light source with best in class color consistency (1 X 2 SDCM)
- Superior light quality with high CRI options of 90 and 95
- World class driver electronics delivering true flicker-free dimming performance
- Cutting edge dimming performance down to 0.1%<sup>2</sup> with 0-10V, DALI-2 and Xmesh wireless control
- Adaptive 2-in-1 fixture design transforms a fixed downlight to adjustable up to 30° tilt
- Classic round or square shape with options of trimmed and trimless to compliment any design
- Flexible lighting design options with variety of light levels, beam angles, and color temperature
- Choose from various install types including retrofit, new construction, and insulated ceilings
- Xicato's Xmesh wireless connectivity enables remote control and monitor from app/dashboard
- Utilize Xicato's smart building ecosystem by adding sensors, switches and asset tags
- Double as emergency lighting with optional battery back-up

### Ordering Logic

Model	Trim/Shape/Type	Output/CRI/CCT	Optics/Reflector	Housing Size/Install Type/Shape	Driver	Output/Wireless	Emergency	
<b>EXAMPLE: E2-WRA-L19030-36DW-E2HBR-X10-L2 (XDL 2" White Round Adaptive Downlight, 765Lm, 90CRI, 3000K, 36 Degree White Reflector, Retrofit Driver Box, XAD 0-10V, For L1)</b>								
<b>Model</b>	<b>Trim</b>	<b>Shape</b>	<b>Function</b>	<b>Output Level</b>	<b>CRI</b>	<b>CCT</b>	<b>Optics</b>	<b>Reflector</b>
E2 XDL 2"	W White B Black T Trimless	R Round S Square	A Adaptive (0° to 30°)	L1 765 Lm	90 90 95 95	27 2700K 30 3000K 35 3500K 40 4000K	18D 18 Degree 24D 24 Degree 36D 36 Degree 50D 50 Degree	W Matte White B Matte Black S Matte Silver CB Chrome Black
<b>Housing Size<sup>3</sup></b>	<b>Install Type</b>	<b>Cutout Shape</b>	<b>Driver</b>	<b>Output Level<sup>4</sup></b>	<b>Emergency Backup<sup>5</sup></b>			
E2H XDL 2" Housing	B Retrofit Driver Box F New Construct Frame I Insulated Ceiling Box	R Round S Square Blank Retrofit or No Housing	X10 0-10V Dim to 1% XD2 DALI-2 Dim to 0.1% X10X 0-10V with Xmesh Dim to 0.1% XD2X DALI-2 with Xmesh Dim to 0.1%	L1 L1 Output	Blank No Emergency E5 Emergency 90min @ 5W			
D2H No Housing	A Air Tight IC Box C Chicago Plenum Blank No Housing							

1. See Xicato 5 Year Limited Warranty

2. Dimming down to 0.1% with Dali-2 and Xmesh; down to 1% with 0-10V

3. Housing can be shipped separately from base downlight

4. Must match Output Level of base downlight

5. All Emergency Backup options are CA Title 20 Compliant and includes remote test switch

## Technical Specifications

Lighting	
LED	Xicato XOB
CCT	2700K, 3000K, 3500K, 4000K
Delivered Lumens	See Table
CRI	CRI ≥90 or CRI ≥95
LED Color Consistency	Xicato XOB with 1x2 SDCM Color Consistency
LED Rated Life (L70)	>50,000Hrs
Optical	
Beam Angle	24°, 30°, 40°, 50°
Lens Material	Polycarbonate
UGR	TBD
Electrical	
Input Voltage	120-277V
Frequency	50/60Hz
Dimmable	Yes, 0-10V to 1%; DALI-2, Xmesh Wireless to 0.1%
Power Consumption	See Table
Efficacy	See Table
Mechanical	
Base/Housing	Integrated Aluminum Heatsink / 16-Gauge Rolled Steel
Trim Finish	Matte White, Matte Black, Trimless
Reflector Finish	White, Black, Silver, Chrome Black, Chrome Silver
Shape	Round, Square
Dimensions (H x Ø Dia)	3.78 x 2.56in (96 x 65mm)
Net Weight	0.35lb (160g)
Max Ambient Temp	35° C (95° F)
Application Type	Adaptive (Adjust from Fixed at 0° to 30° Tilt)
Installation	Retrofit, New Construction, Insulated Ceiling
Certification and Warranty	
Certification	ETL, UL2108, FCC, CE, UKCA, CA Title 24 JA8, RoHS
Environmental Rating	Damp Location Rated
Warranty	5 years Limited

Performance and Efficacy*			
Model	Output (lm)	Power (W)	Efficacy (lm/W)
L1	765	11	70

\*Data based on 3000K CRI 90 36° Optics as baseline

Lumen Conversion**		
CCT	CRI	Ratio
3000K	90	1
2700K	90	0.95
3500K	90	1.02
4000K	90	1.03
2700K	95	0.84
3000K	95	0.89
3500K	95	0.91
4000K	95	0.92
Beam Angle		Ratio
18°		0.75
24°		0.78
36°		1
50°		0.92

\*\*All conversion based on 3000K CRI 90 Fixed as baseline

Emergency Battery Back-Up		
Battery Option		Est. Output Level
E5	90min @ 5W	~59%

All data shown is nominal. Specifications and data are subject to change without notice.

## Dimensional Drawings

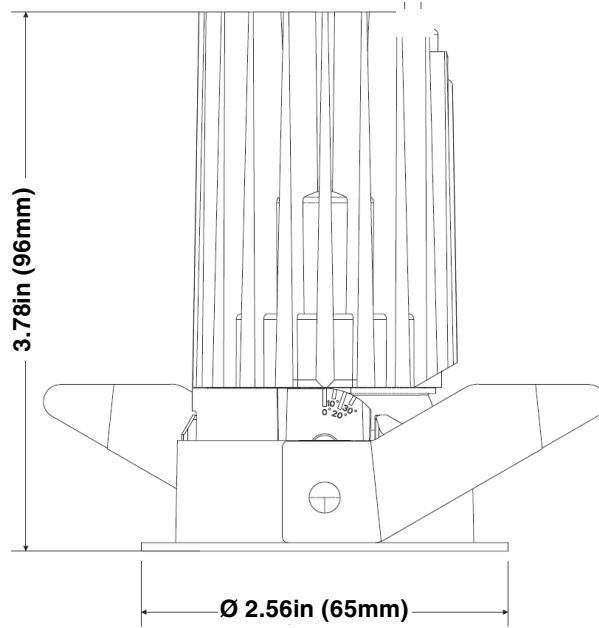

## Other Dimensions

### New Construction Plaster Plate

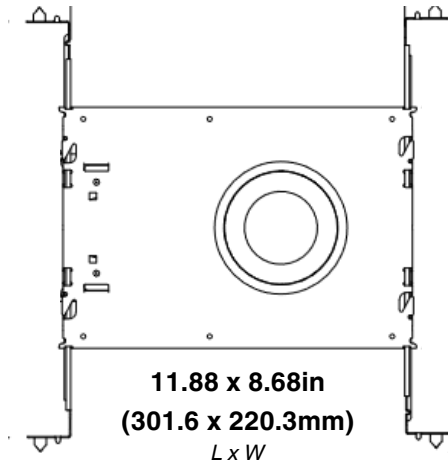

### IC / ICAT / Chicago Plenum

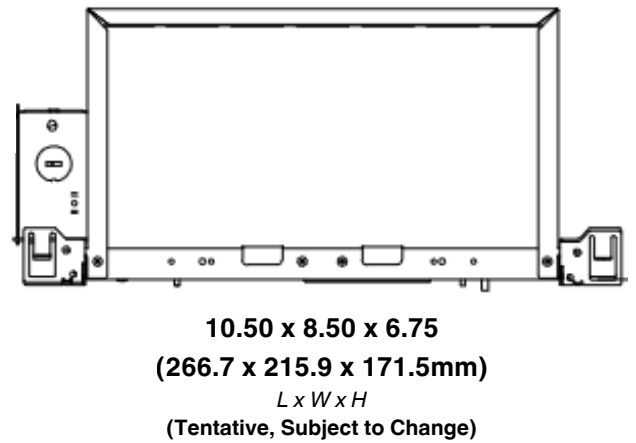

## Ceiling Cutout Dimension

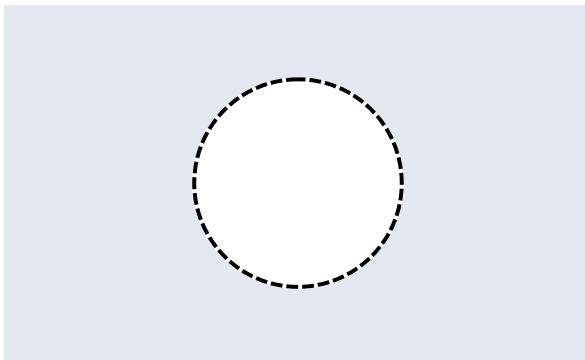

**Round**  
Ø 2.16" (55mm)

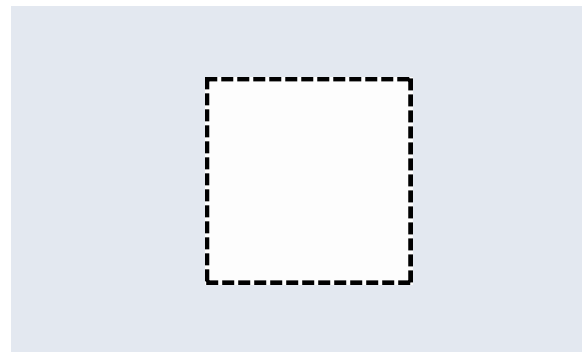

**Square**  
2.16" x 2.16" (55 x 55mm)

## Color Specification: TM-30 for Xicato XOB 3000K CRI 90

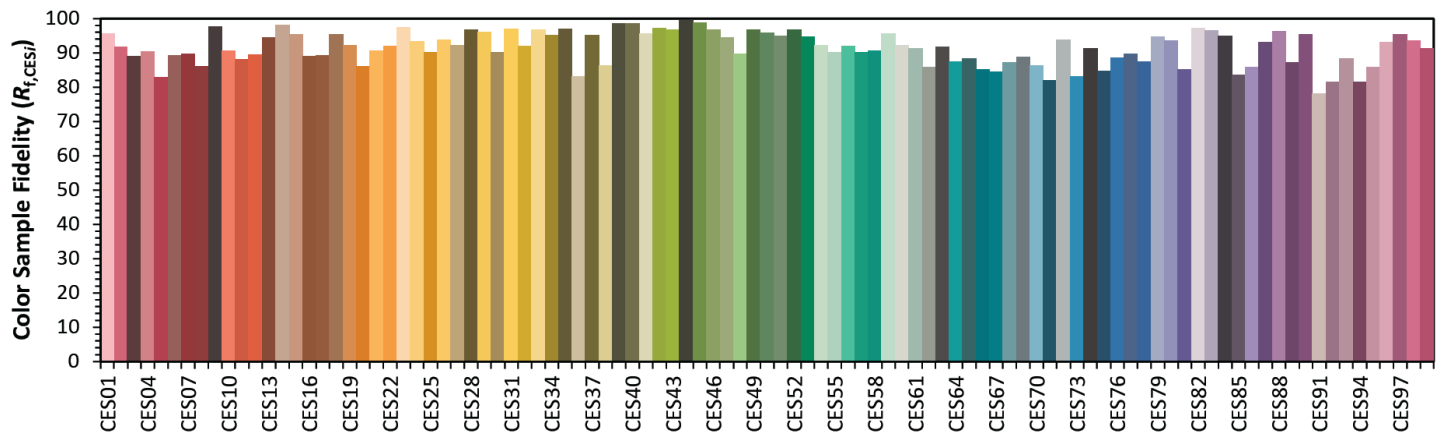
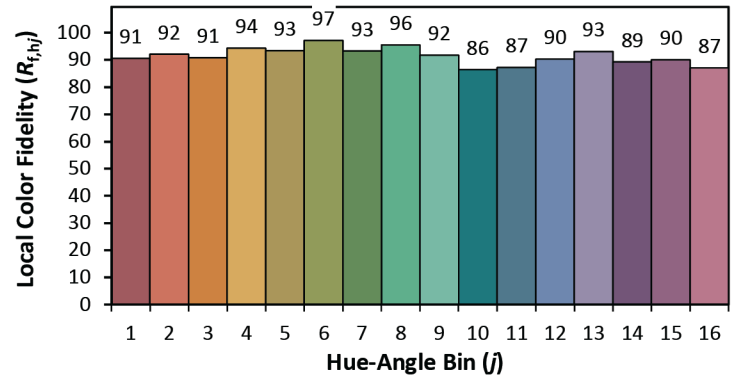
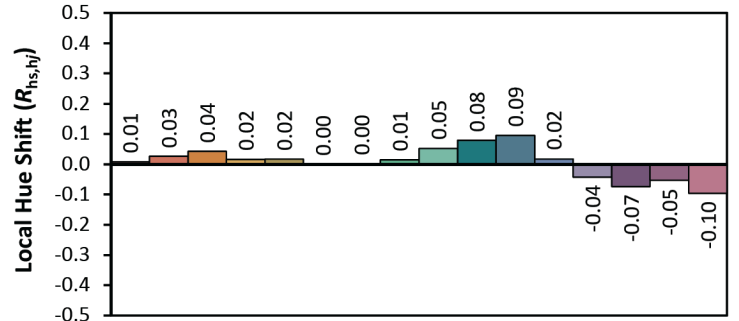
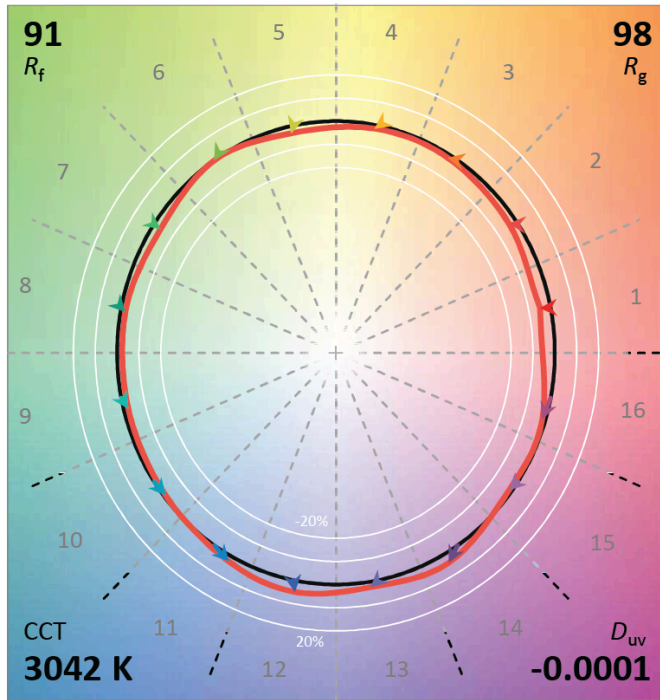
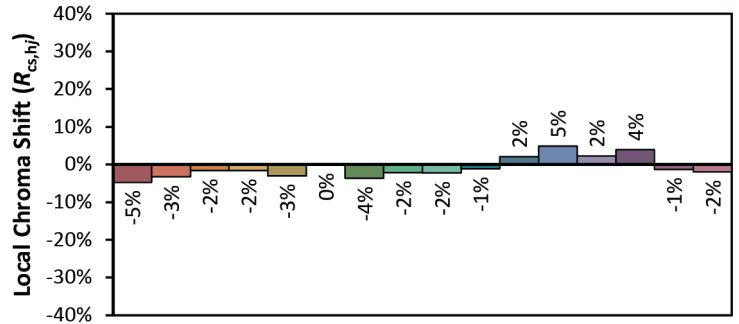
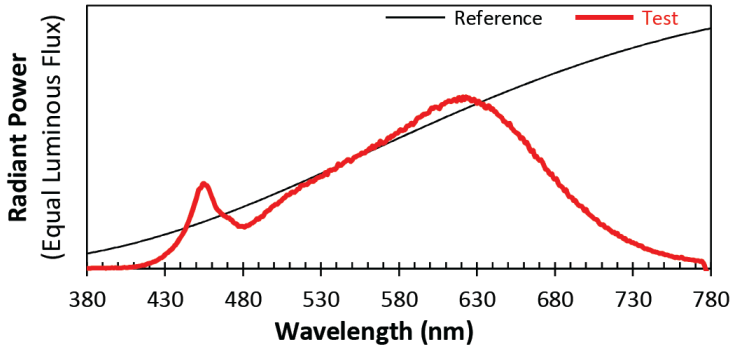

**Notes:** This is a recommended method for displaying IES TM-30-18 information.

x **0.4381**  
 y **0.4043**  
 u' **0.2512**  
 v' **0.5216**

CIE 13.3-1995  
 (CRI)  
 Ra **93**  
 Rg **64**

Colors are for visual orientation purposes only. Created with the IES TM-30-18 Calculator v2.0.

## Color Specification: TM-30 for Xicato XOB 3000K CRI 95

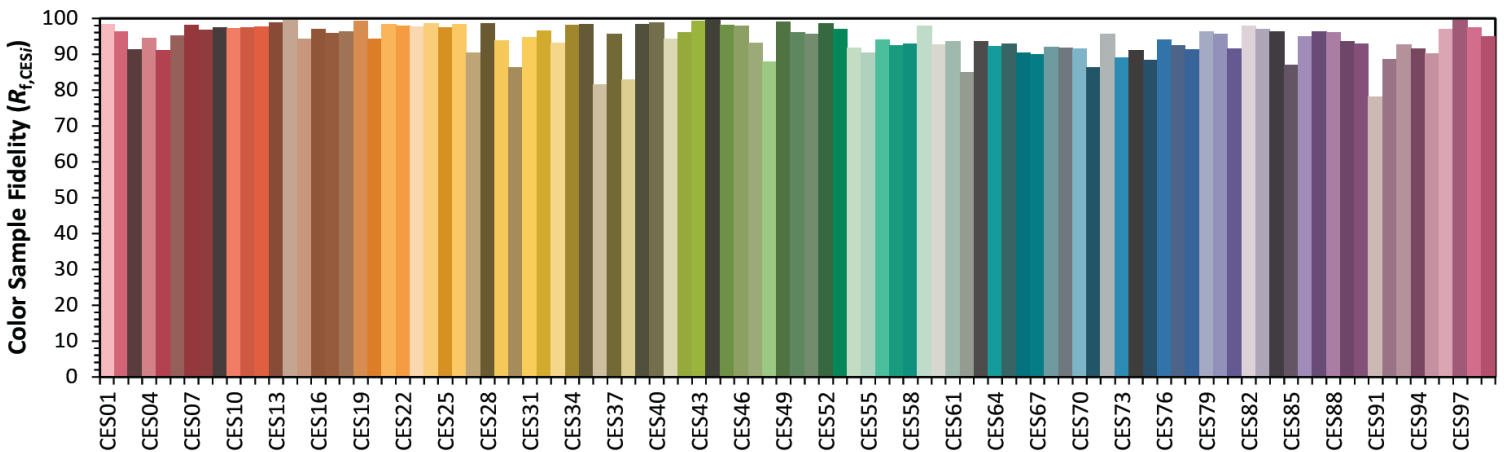
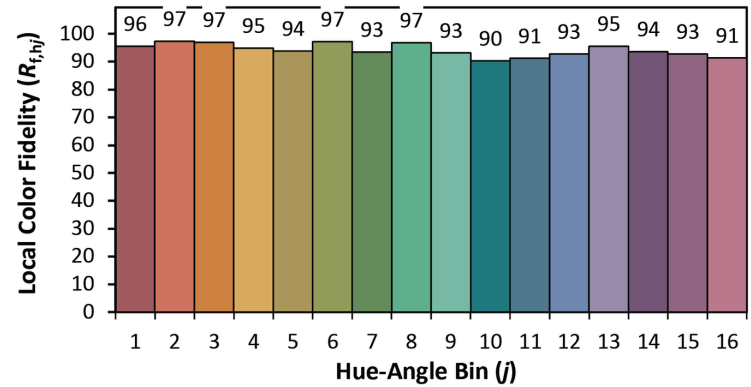
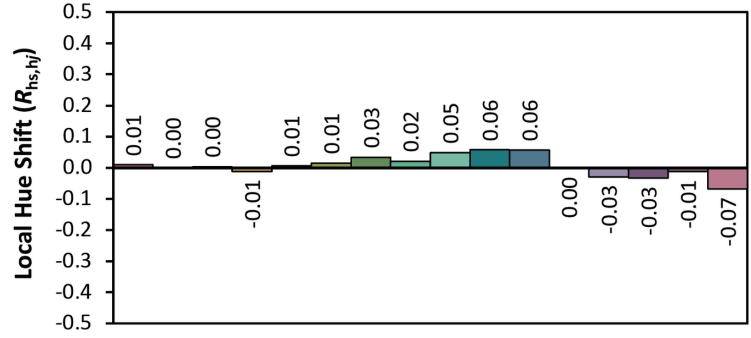
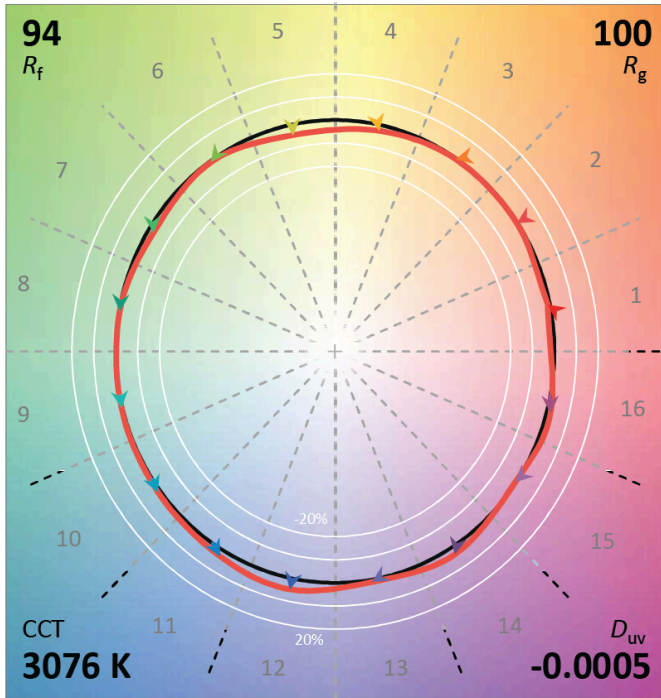
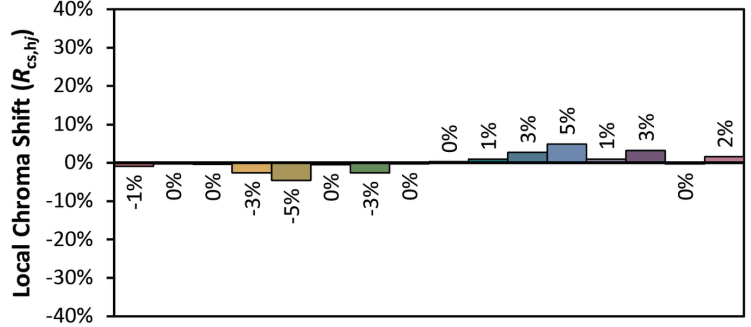
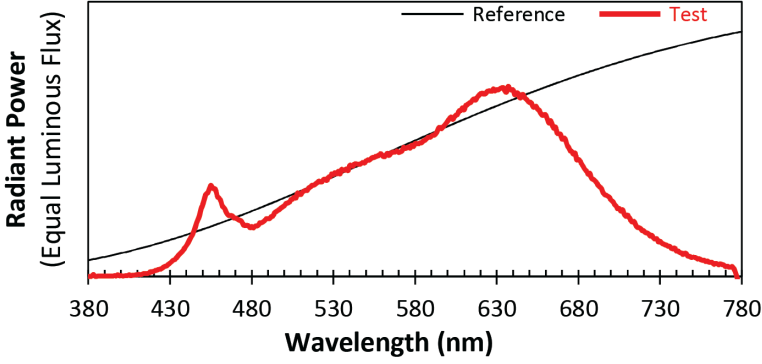

**Notes:** This is a recommended method for displaying IES TM-30-18 information.

x **0.4352**  
 y **0.4022**  
 u' **0.2502**  
 v' **0.5204**

CIE 13.3-1995 (CRI)	
$R_a$	98
$R_g$	95

Colors are for visual orientation purposes only. Created with the IES TM-30-18 Calculator v2.0.