

## Wireless 2-Button Wall Switch with Occupancy Sensor

PSC-DM-I-WS-200-BLE-XI

### Product Overview

- Xicato Xmesh™ Wall Switch
- Passive Infrared (PIR) Occupancy/Vacancy Sensor
- Programmable Buttons
  - Button press<sup>1</sup>
  - On/Off
  - Dim Up/Down
  - Scene recall
  - Color Tuning
- LED status indicator light
- AC (120-277Vac) powered
- Mounts in any standard wall box
- White Color

### Applications

Xicato's Xmesh Wireless 2-Button Wall Switch with integrated PIR Occupancy Sensor (PSC-DM-I-WS-200-BLE-XI) wirelessly communicates with Xmesh lights, gateways, controllers and sensors to provide control of lighting in the space. The switch can be installed in a standard single gang wall box for new work or retrofit applications.

The buttons on the PSC-DM-I-WS-200-BLE-XI are field customizable to provide the desired switch functionality. The PIR sensor provides separate reporting for setting up occupancy or vacancy-based lighting control in a room or area.

Typical applications are any location where direct access controls are desired such as offices, conference rooms, classrooms, storage spaces, kitchens, bathrooms, bedrooms, etc.

### Operation

**Xicato Xmesh Wireless Controls** provide a seamless mesh-based control system for rooms, floors, buildings and sites. The controls system includes lights, switches, load controllers as well as gateways that provide easy local or remote system monitoring and integration with a BMS or other lighting control systems.

Xicato's Xmesh controls system features a highly resilient architecture without a single point of failure. Easy ability to move and reconfigure devices after installation. Auto-discovery of new devices making it easy to expand your system with both devices and capabilities.

**Configuration:** The operation of the switch as well as all Xmesh connected devices can be programmed using Xicato's design and commissioning tools. The operation of a device can be programmed to provide nearly any desired operation ranging from on/off and dim up/down to command sequencing, lighting animation, schedule-based operation and more.



### Specifications

**Type:** 2-Button Wall Switch with PIR Occupancy/Vacancy Sensor  
**Input Voltage:** 120-277Vac 50/60Hz  
**Power Consumption:** Max 1.5W  
**Mounting:** Standard single-gang wall box  
**Max Sensor Range:** 40ft at 4ft mounting height (12.2m at 1.2m mounting height)  
**Max Bluetooth Range<sup>2</sup>:** 30ft (9.14m)  
**Operating Temperature:** 0° to 55°C  
**Storage Temperature:** -10° to 60°C  
**Relative Humidity:** 90-95% non-condensing  
**Color:** White  
**Warranty:** 5 years

Note:

1. Factory Default Configuration

2. Bluetooth Range is highly dependent on the integration of fixtures, surrounding environment and conditions. It is recommended to conduct testing for range accuracy.

Xicato designs and delivers one of the broadest portfolio spot and linear light sources and controls that enable architects, designers and building managers to create beautiful, smart spaces in which people love to live and work. With thousands of installations around the globe, Xicato continues to be a leading supplier of high quality lighting solutions. Xicato is defining the future of intelligent light sources by integrating electronics, software and connectivity. Xicato's headquarters is based in Silicon Valley and the company has offices Worldwide.

Physical Dimensions

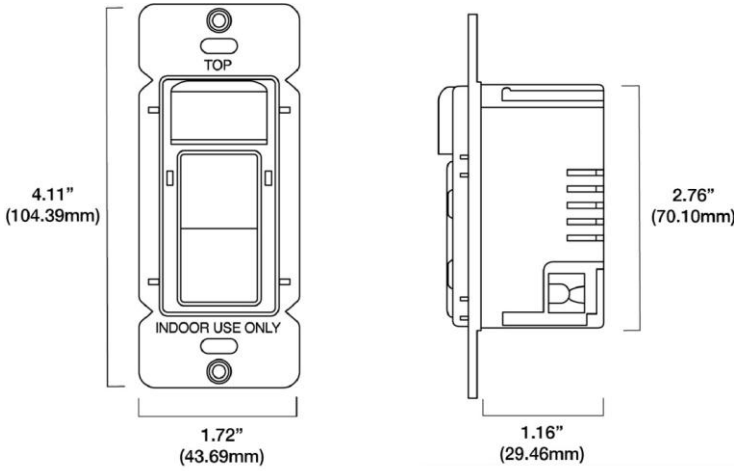

Wiring Diagram

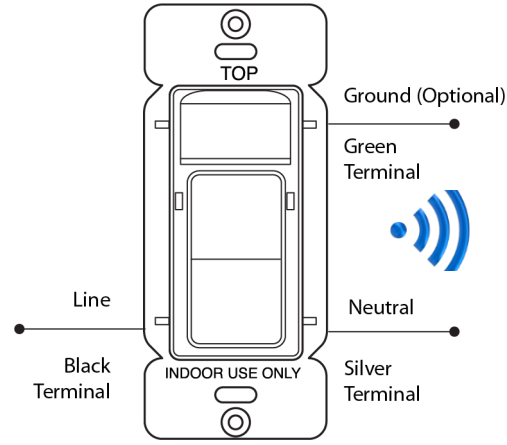

Application Example

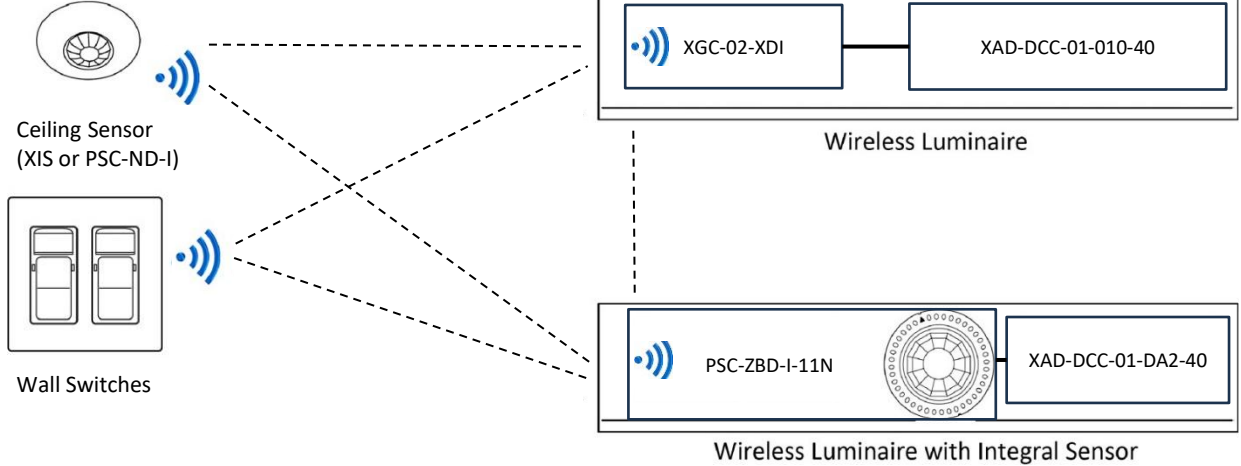

Wireless Controls

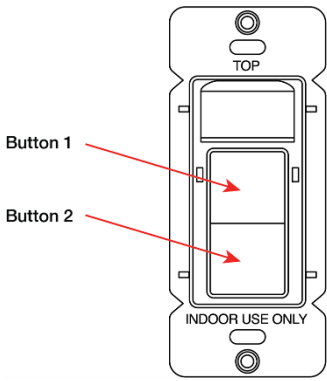

- Default Switch Button Action**
- The default factory programming for Buttons 1 and 2 is for the switch to signal short or long duration button press events. These events can be utilized to control Xmesh™ lights through programming of the response engine contained in each Xmesh™ controlled light.
  - Alternate actions can be programmed into the buttons through Xicato's commissioning tools. These actions include, but are not limited to:
    - Direct intensity
    - Scene recall
    - Dim up/dim down
    - Multi-function sequences

Sensor Detection Area

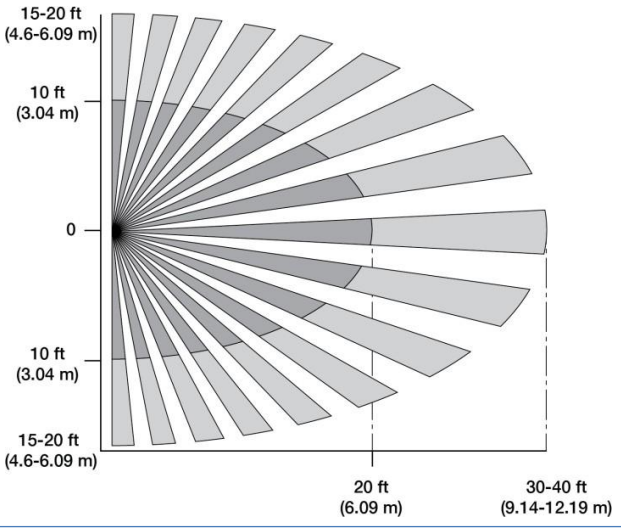

Ordering Information

Part Number	Description
PSC-DM-I-WS-200-BLE-XI	AC powered (120-277Vac) Xmesh™ 2-Button Wall Switch with PIR Occupancy Sensor (decorator faceplate not included)

Note: Drawings are not to scale. Design and specifications are subject to change without notice.